

Parallelepiped Upholstered Cushion



UPHOLSTERED CUSHION

Frequent usage

Physiotherapy

Rehabilitation

Osteopathy

Chiropractic

Massage

Gentle Gymnastics.

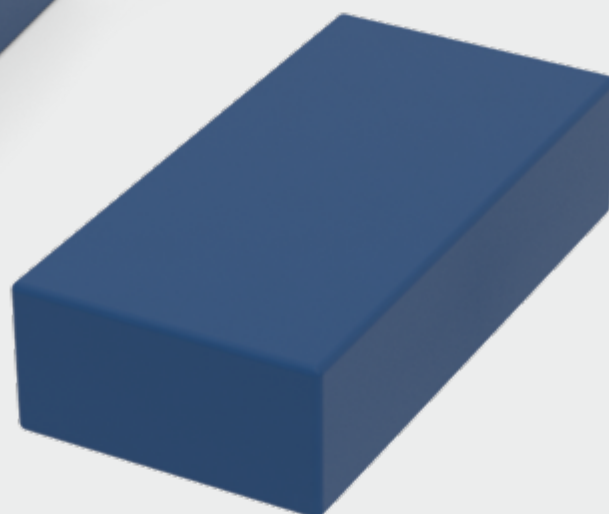
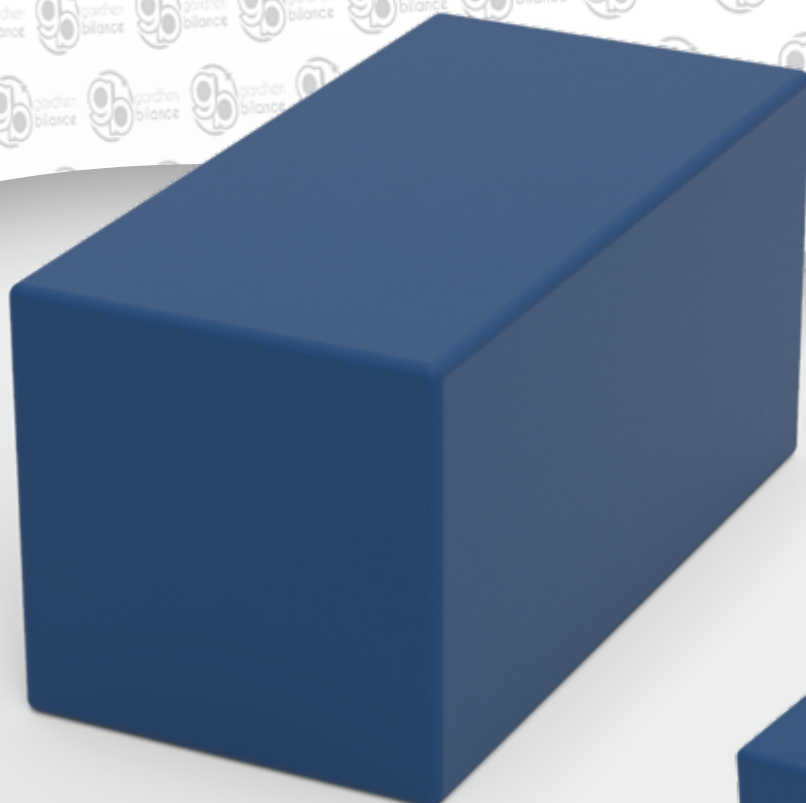

Coated positioner cushions are a valuable tool for doctors and patients in the post-operative course and rehabilitation process.

These are medical devices designed to facilitate to place the patient into correct position during physiotherapy and rehabilitation sessions, hospitalization or rest.

Our positioner cushions are made of polyurethane foam and can be upholstered in water-repellent PVC black fabric or in leatherette, available in different colors.

Benefits



- Effectiveness during physical therapy sessions;
- Effectiveness during rehabilitation sessions;
- Effectiveness to prevent abrasions;
- Effectiveness to prevent decubitus wounds.

Features



- Polyurethanic foam
- 100% latex free
- Non-sterile
- 2 years lifespan

Colour chart



Scan the QR code to see our colour chart



Dimensions



ID Product	Dimensions
GB.0006PUR01	L. 20 x P 40 x H. 10 cm
GB.0006PUR02	L. 25 x P 50 x H. 25 cm
GB.0006PUR03	L. 16 x P 24 x H. 5 cm
GB.0006PUR04	L. 16 x P 24 x H. 8 cm
GB.0006PUR05	L. 16 x P 24 x H. 11 cm

Technical sheet



GMDN Code	41058
Basic UDI-DI	805771740POSPU
Intended use	Upholstered cushion
Manufacturer	GARDHEN BALANCE SRL
Class	Class I

For certifications please refer to "Certifications and Quality system" section.

Pictures contained in this brochure is for illustrative purpose only. The manufacturer reserves the right to modify the projects without notice. For accessories identification please refer to the accessory catalogue or commercial offer. When data are different please refer to commercial offer.
Dep. EN_275 rev.06/05/2022

